

THE
Meritage
RESORT AND SPA.

VISTA COLLINA
RESORT

Meeting Diagrams & Capacity Charts



Event Space at a Glance

The Meritage Resort and Spa

| Room Name | Dimensions | Usable Sq Ft | Ceiling Height | Reception | Rounds (10 Per 66") | Classroom (3 Per 6') | Theater | Conference | U-Shape | Hollow Square | 6' Display Tables | Booths (8' X 10') | Booths (10' X 10') |
|---------------------------------|-------------|--------------|----------------|-----------|---------------------|----------------------|---------|------------|---------|---------------|-------------------|-------------------|--------------------|
| Meritage Ballroom | | | | | | | | | | | | | |
| Meritage Grand Salon | 145' X 77' | 10,490' | 14' | 1,104 | 770 | 720 | 1,000 | ~ | ~ | 280 | 87 | 64 | 52 |
| Meritage Ballroom | 142' X 57' | 8,370' | 14' | 881 | 600 | 575 | 800 | ~ | ~ | ~ | 64 | 57 | 42 |
| Meritage Pre-Function | 109' X 20' | 2,128' | 16' | 125 | 70 | 145 | 180 | 80 | ~ | 60 | 18 | 7 | 5 |
| Salon I | 35' X 23' | 815' | 14' | 86 | 50 | 34 | 64 | 20 | 20 | 24 | 7 | 5 | 4 |
| Salon II | 35' X 33' | 1,198' | 14' | 126 | 90 | 52 | 90 | 24 | 30 | 36 | 10 | 7 | 6 |
| Salon III | 23' X 23' | 523' | 14' | 55 | 40 | 24 | 36 | 16 | 18 | 20 | 4 | 3 | 3 |
| Salon IV | 23' X 33' | 788' | 14' | 83 | 40 | 30 | 40 | 20 | 18 | 24 | 7 | 5 | 4 |
| Salon V | 23' X 23' | 523' | 14' | 55 | 30 | 27 | 30 | 15 | 18 | 20 | 4 | 3 | 3 |
| Salon VI | 23' X 35' | 788' | 14' | 83 | 50 | 30 | 40 | 20 | 18 | 24 | 7 | 5 | 4 |
| Salon VII | 35' X 23' | 776' | 14' | 82 | 50 | 30 | 50 | 20 | 18 | 24 | 6 | 5 | 4 |
| Salon VIII | 35' X 33' | 1,178' | 14' | 124 | 80 | 50 | 90 | 28 | 30 | 40 | 10 | 7 | 6 |
| Salon IX | 28' X 23' | 626' | 14' | 55 | 30 | 24 | 40 | 20 | 20 | 24 | 5 | 4 | 3 |
| Salon X | 28' X 40' | 1,110' | 14' | 117 | 60 | 42 | 80 | 24 | 30 | 34 | 10 | 7 | 6 |
| Meritage Patio | 14' X 102' | 1,420' | 9' | 149 | 118 | ~ | ~ | ~ | ~ | ~ | ~ | ~ | ~ |
| Cabernet Room | 15' X 30' | 477' | 14' | 40 | 30 | 24 | 40 | 24 | 16 | ~ | 4 | 3 | 2 |
| Petit Verdot Room | 17' X 26' | 422' | 14' | ~ | ~ | ~ | ~ | 12 | ~ | ~ | ~ | ~ | ~ |
| Vineyard Terrace | 24' X 137' | 3,251' | 9' | 350 | 200 | ~ | ~ | ~ | ~ | ~ | ~ | ~ | ~ |
| Vineyard Pre-Function | 16' X 133' | 2,188' | 9.6' | 125 | ~ | ~ | ~ | ~ | ~ | ~ | 18 | 14 | 11 |
| Carneros Ballroom | | | | | | | | | | | | | |
| The Carneros Ballroom | 108' X 72' | 7,358' | 17' | 800 | 630 | 525 | 850 | ~ | ~ | ~ | ~ | 47 | 40 |
| The Carneros Pre-Function Space | 92' X 21' | 1,564' | 12' | 150 | 120 | 100 | 160 | 44 | 36 | 40 | 11 | 9 | 7 |
| Salon A | 35' X 29' | 998' | 17' | 110 | 80 | 69 | 111 | 36 | 25 | 24 | 10 | 8 | 6 |
| Salon B | 35' X 25' | 875' | 17' | 90 | 70 | 57 | 90 | 25 | 20 | 30 | 9 | 6 | 5 |
| Salon C | 35' X 25' | 875' | 17' | 90 | 70 | 57 | 90 | 25 | 20 | 30 | 9 | 6 | 5 |
| Salon D | 29' X 17.5' | 496' | 17' | 30 | 20 | 18 | 30 | 18 | 14 | 12 | 4 | 2 | 2 |
| Salon E | 29' X 17.5' | 491' | 17' | 30 | 20 | 18 | 30 | 18 | 14 | 12 | 4 | 2 | 2 |
| Salon F | 29' X 17.5' | 491' | 17' | 30 | 20 | 18 | 30 | 18 | 14 | 12 | 4 | 2 | 2 |
| Salon G | 29' X 19' | 533' | 17' | 30 | 20 | 18 | 30 | 18 | 14 | 20 | 4 | 2 | 2 |
| Salon H | 37' X 25' | 875' | 17' | 95 | 70 | 60 | 100 | 32 | 25 | 24 | 9 | 7 | 6 |
| Salon J | 37' X 25' | 875' | 17' | 95 | 70 | 60 | 100 | 32 | 25 | 24 | 9 | 7 | 6 |
| Salon K | 37' X 29' | 1,035' | 17' | 111 | 80 | 72 | 116 | 40 | 28 | 26 | 14 | 9 | 8 |
| Oakville Terrace | 102' X 34' | 2,485' | 11' | 295 | 180 | ~ | ~ | ~ | ~ | ~ | 20 | 17 | 14 |
| Rutherford Terrace | 35' X 24' | 840' | 11' | 89 | 50 | 57 | 94 | 24 | 20 | 20 | 8 | 4 | 2 |
| Oakville & Rutherford Terraces | ~ | 3,821' | 11' | 379 | 240 | ~ | ~ | ~ | ~ | ~ | 30 | 25 | 20 |
| Merlot Room | 19' X 13' | 250' | 10' | 24 | 20 | 16 | 20 | 10 | ~ | ~ | ~ | ~ | ~ |
| Trinitas Board Room | 25' X 16' | 426' | 10' | ~ | ~ | ~ | ~ | 12 | ~ | ~ | ~ | ~ | ~ |
| Piazza, Pergola, Activity Lawn | ~ | 7,672' | ~ | 800 | 650 | ~ | 200 | ~ | ~ | ~ | ~ | ~ | ~ |
| Fountain Courtyard | 37' X 58' | 2,146' | ~ | 350 | 250 | ~ | 450 | ~ | ~ | ~ | ~ | ~ | ~ |
| Estate Cave | | | | | | | | | | | | | |
| Estate Entertainment Cave | 23' X 140' | 3,892' | 18' | 200 | 200 | 180 | 200 | 80 | 80 | 85 | 25 | 19 | 15 |
| Vineyard Deck | | | | | | | | | | | | | |
| Vineyard Deck (Upper) | ~ | 2,350' | ~ | 250 | 90 | ~ | 270 | ~ | ~ | ~ | ~ | ~ | ~ |
| Vineyard Deck (Lower) | ~ | 1,396' | ~ | 120 | 70 | ~ | 150 | ~ | ~ | ~ | ~ | ~ | ~ |
| Vineyard Deck (Combined) | ~ | 3,746' | ~ | 370 | 160 | ~ | 420 | ~ | ~ | ~ | ~ | ~ | ~ |

Vista Collina Resort

| Room Name | Dimensions | Usable Sq Ft | Ceiling Height | Reception | Rounds (10 Per 66") | Classroom (3 Per 6') | Theater | Conference | U-Shape | Hollow Square | 6' Display Tables | Booths (8' X 10') | Booths (10' X 10') |
|--------------------|---------------|--------------|----------------|-----------|---------------------|-----------------------------------|---------|------------|---------|---------------|-------------------|-------------------|--------------------|
| Village Lawn | 73' X 148' | 16,570' | ~ | 1,500 | 1,000 | ~ | 1,500 | ~ | ~ | ~ | ~ | ~ | ~ |
| Rooftop Terrace | ~ | 2,121' | ~ | 120 | 90 | ~ | ~ | ~ | ~ | ~ | ~ | ~ | ~ |
| Rooftop Lounge | 20.5' X 36' | 750' | ~ | 50 | 50 | 42 (3 per 6') or 28 (2 per 6') | 72 | 36 | 36 | 36 | 15 | 3 | 3 |
| Vintner's Room | ~ | 2,408' | ~ | 60 | 120 (king's tables) | 54 | ~ | ~ | ~ | ~ | ~ | ~ | ~ |
| Wellness Lawn | 26.9' X 31.9' | 936' | ~ | 120 | 80 | ~ | 112 | 72 | ~ | ~ | 24 | 9 | 9 |
| Pool Lawn | 24.8' X 20.5' | 500' | ~ | 50 | ~ | ~ | ~ | ~ | ~ | ~ | ~ | ~ | ~ |
| Food & Wine Center | ~ | 2,075' | ~ | ~ | ~ | ~ | ~ | ~ | ~ | ~ | ~ | ~ | ~ |

Up to 20 students for a dinner or lunch class; Up to 40 for a baking class or wine tasting

The Meritage Resort and Spa Meeting Space Diagrams

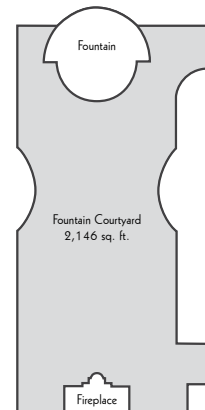
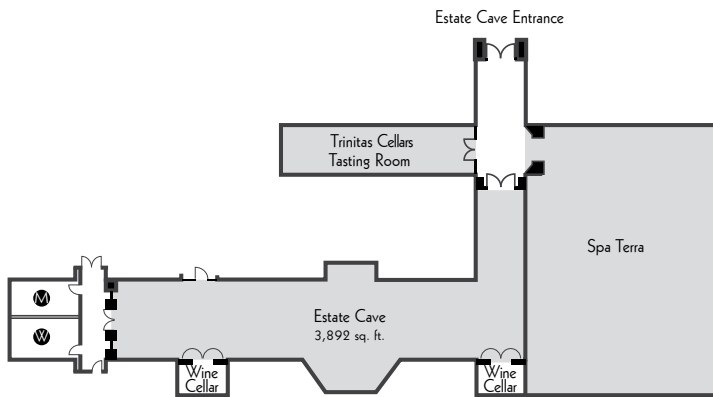
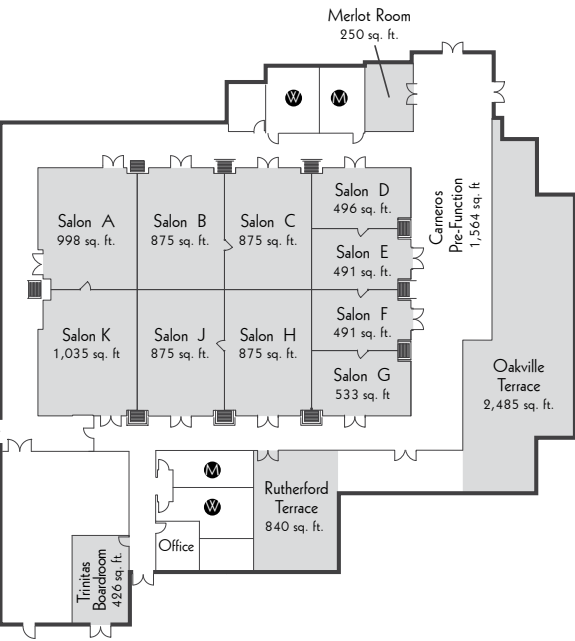
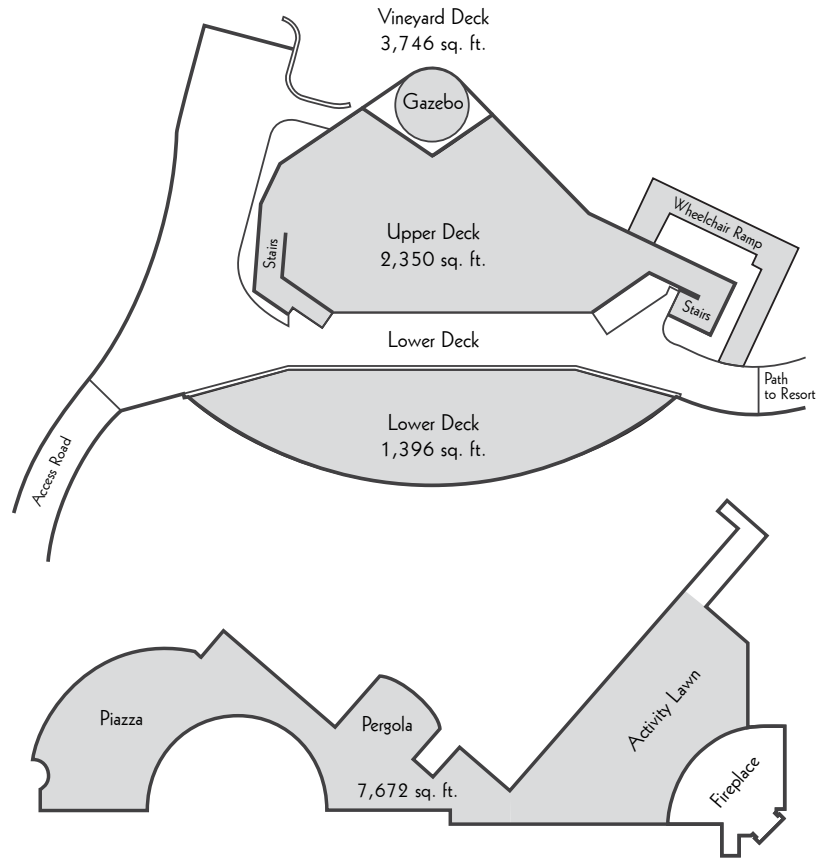
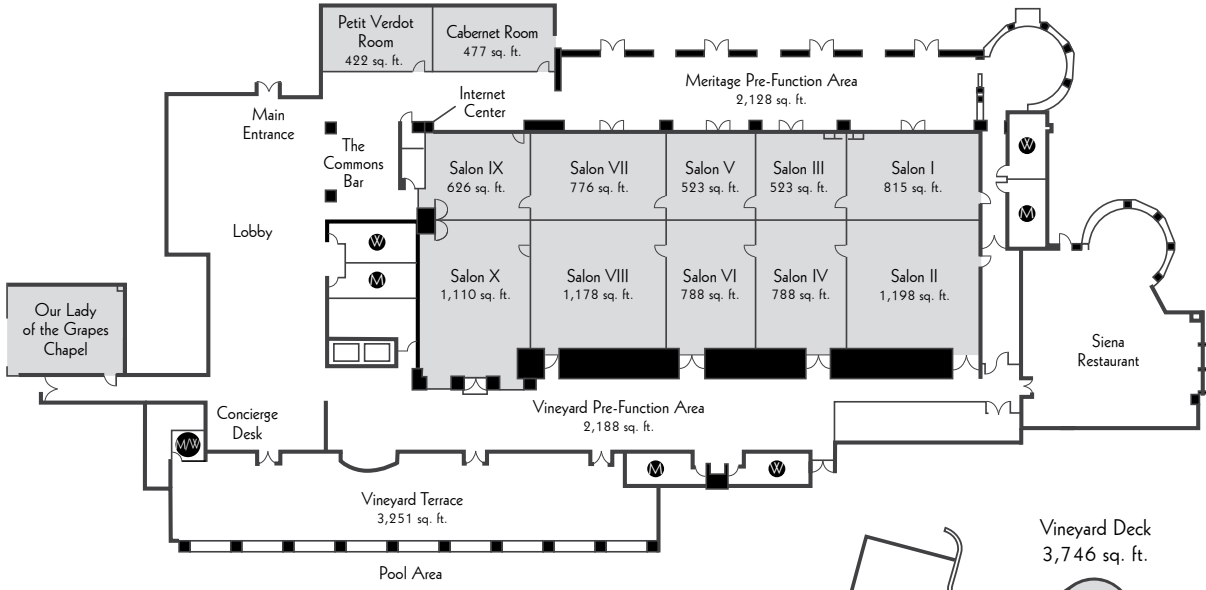

Vista Collina Resort Meeting Space Diagrams

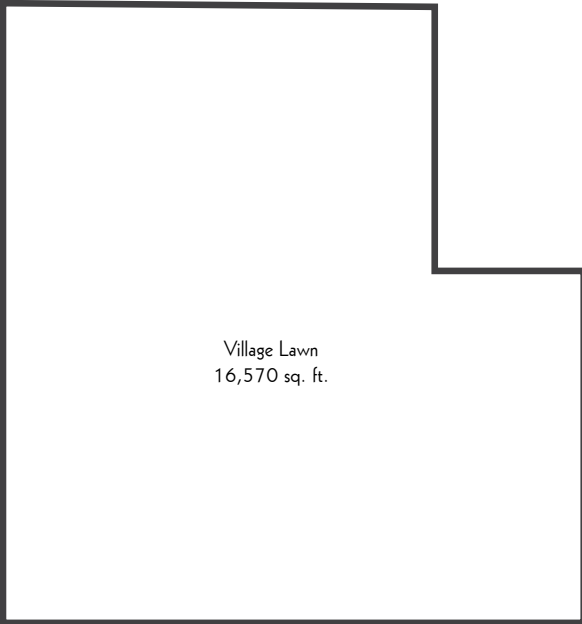
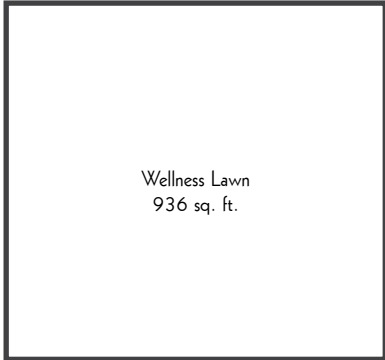
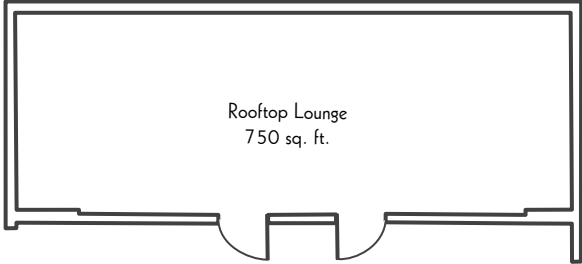
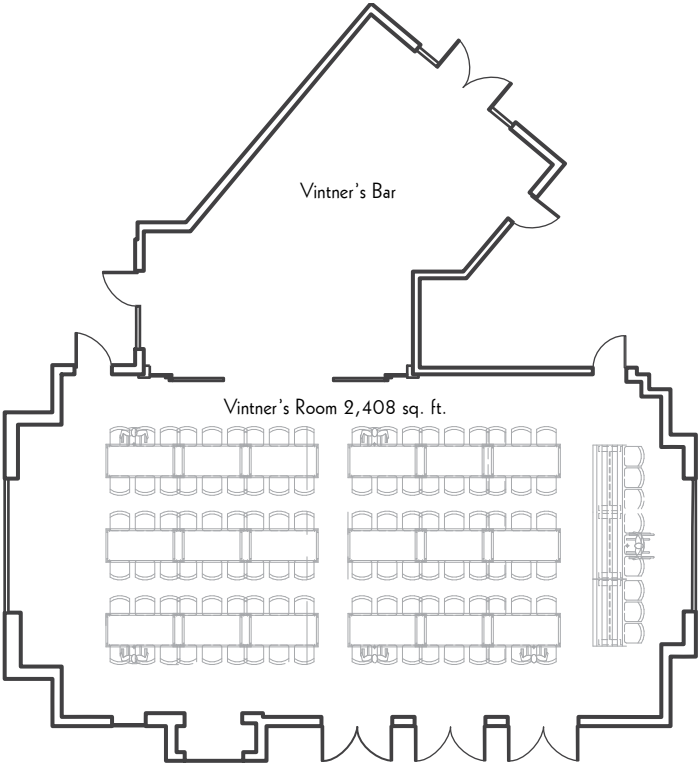
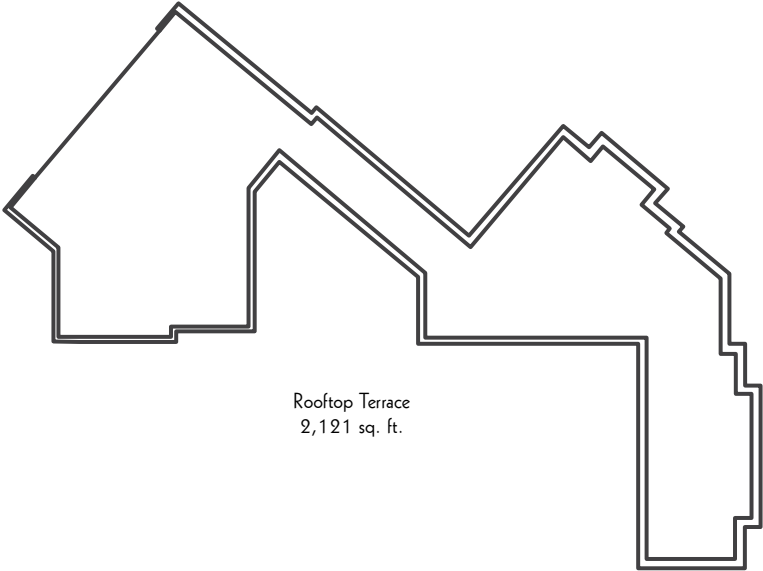
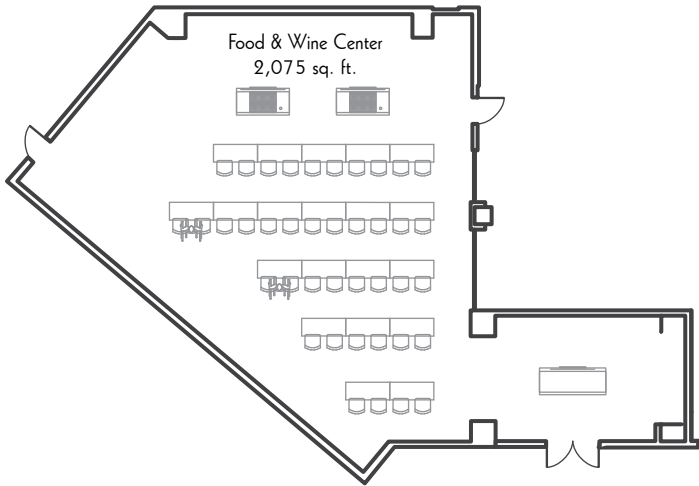





Two Resorts. One Exceptional Destination.

The Meritage Resort and Spa and the adjacent Vista Collina Resort (opening summer 2018) combine to create one exceptional destination. From a morning tai chi event on the Village Lawn to breakout meetings in our ballrooms, cocktail receptions on the Vineyard Deck or a celebratory dinner in the Estate Cave, Vista Collina and The Meritage Resort and Spa can host any type of event you dream up. And with an experienced and dedicated sales, culinary and technical team, you can rest assured that the planning and execution of your event will be seamless.

- 467 guestrooms, suites and luxury retreats
- 80,000 square feet of indoor and outdoor function space
- 44 unique venues
- Private nine-acre vineyard with event deck and walking trails
- World-class spa accommodating up to 100 treatments per day
- Crush Lounge with six lanes of bowling
- The Village, featuring nine tastings rooms, Fivetown Grocery and a Food & Wine Center
- 16,000-square-foot Village Lawn for outdoor concerts, movies and special events
- Rooftop Terrace overlooking stunning hillside views
- Grand Estate cave, located 40 feet underground, for exceptional wine dinners
- Two pools, Jacuzzis and fitness centers

Contact us now:

THE
Meritage
RESORT AND SPA.

VISTA COLLINA
RESORT

877-537-8874 | sales@meritageresort.com
www.meritageresort.com/meetings